

SQUARE FOOTAGE

1st FLOOR LIVING	2193
2nd FLOOR LIVING	717
TOTAL LIVING	2910
FRONT PORCH	144
REAR PORCH	435
GARAGE	571
STORAGE	379
TOTAL	4439

DO NOT REPRODUCE THIS PLAN
 Construction By:
CORBIN LADNER CUSTOM HOMES, LLC
 Address: 84
 Hollows of Dutchtown
 Ascension Parish
 THIS PLAN INTENDED FOR USE ON THE ABOVE LISTED LOT ONLY

1st FLOOR PLAN
 Scale: 1/4"=1'-0"

DOORS			WINDOWS		
MARK	SIZE	THK	MARK	SIZE	LTS
(1)	3-2 x 8-0	1 3/4"	(A)	2-8 x 7-0	1/1
(2)	2-8 x 8-0	1 3/4"	(B)	2-8 x 6-0	1/1
(3)	2-8 x 6-8	1 3/4"	(C)	4-0 x 4-0	1
(4)	3-0 x 6-8	1 3/4"	(D)	3-0 x 8-0	1/1
(5)	18-0 x 8-0	Std.	(E)	2-8 x 5-0	1/1
(6)	2-4 x 6-8	1 3/4"	(F)	2-8 x 8-0	4/2
(7)	2-0 x 6-8	1 3/4"	(G)	3-0 x 6-0	
(8)	2-8 x 6-8	1 3/4"	(H)	2-0 x 3-0	1/1
(9)	1-4 x 6-8	1 3/4"	(I)	1-0 x 7-0	1/1
(10)	3-0 x 8-0	Std.	(J)	3-0 x 8-0	
(11)	3-8 x 8-0	Std.			
(12)	10-0 x 8-0	Std.			
(13)	3-0 x 6-8				
(14)	3-0 x 8-0				

WINDOW NOTE:
 1. ALL FRONT WINDOWS MUST HAVE RAISED MULLION LITE DIVIDERS.

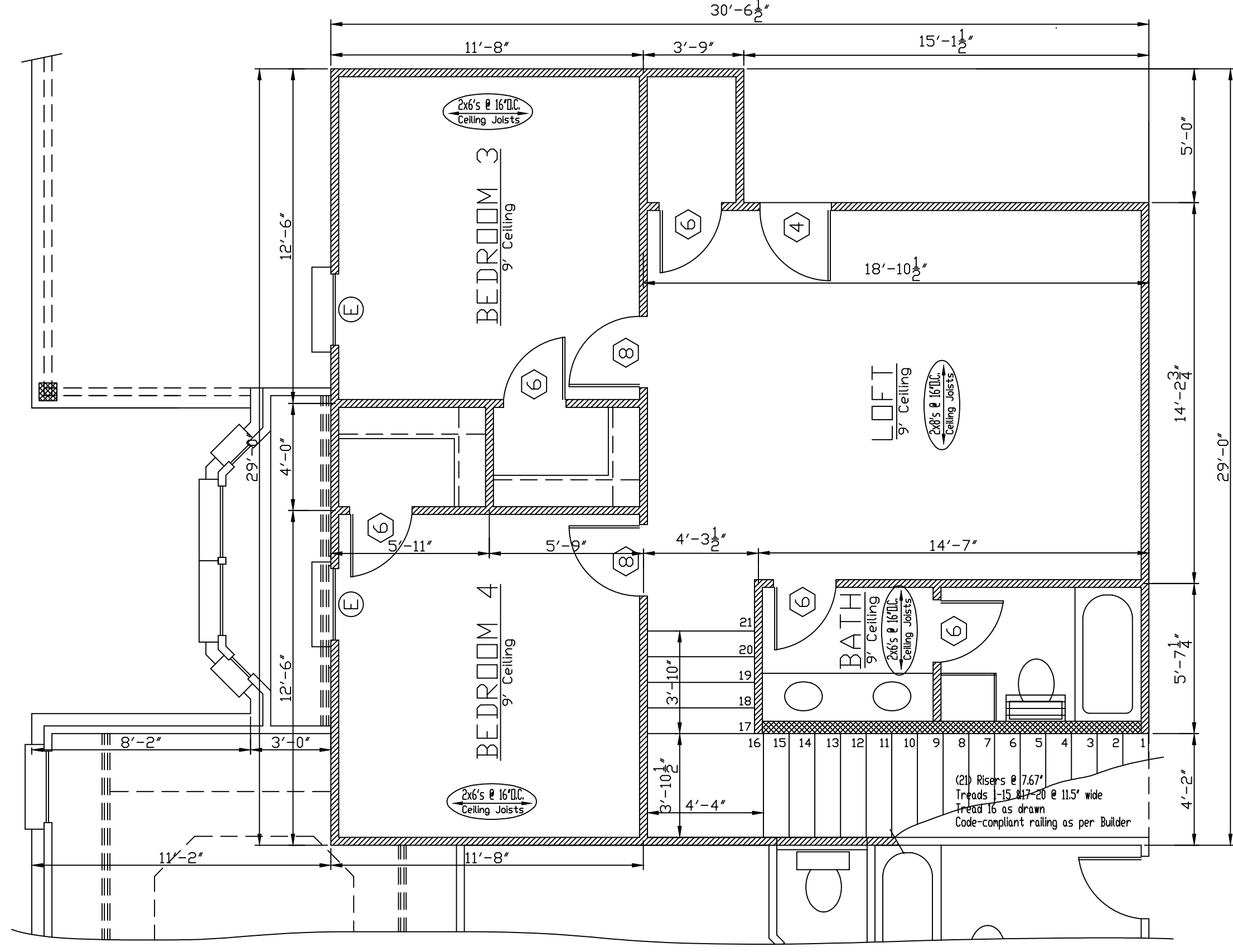

2nd FLOOR PLAN
 Scale: 1/4"=1'-0"

- GENERAL NOTES:**
- THIS HOME DESIGN IS THE PROPERTY OF HOME DESIGNS OF BATON ROUGE. ANY REUSE OR REPRODUCTION OF THIS PLAN IS PROHIBITED.
 - CONTRACTOR IS RESPONSIBLE FOR VERIFICATION OF ALL DIMENSIONS PRIOR TO CONSTRUCTION.
 - FIREPLACE SIZE AND DESIGN SHALL BE BY CONTRACTOR AT TIME OF CONSTRUCTION.
 - ALL ANGLED WALLS ARE AT 45 DEGREES UNLESS OTHERWISE NOTED.
 - SEE SHEET 2/7 FOR FRONT, REAR AND SIDE ELEVATIONS.
 - SEE SHEET 3/7 FOR ELECTRICAL PLAN.
 - SEE SHEET 4/7 FOR H.V.A.C. PLAN.
 - SEE SHEET 5/7 FOR FOUNDATION PLAN AND ROOF CUT PLAN.
 - SEE SHEET 6/7 FOR 1st FLOOR JOIST PLAN AND 2nd STORY SECTION PLAN.
 - SEE SHEET 7/7 FOR TYPICAL CONSTRUCTION DETAILS.
 - SEE ATTACHMENTS FOR PLOT PLAN AND RESCHECK.

- SPECIAL NOTES:**
- HOME DESIGNS OF BATON ROUGE HAS MADE EVERY EFFORT TO INSURE THE ACCURACY OF THIS PLAN. HOWEVER, IT IS THE RESPONSIBILITY OF THE CONTRACTOR/OWNER TO VERIFY THE DIMENSIONAL CORRECTNESS, STRUCTURAL INTEGRITY AND CODE COMPLIANCE ASPECTS OF THIS PLAN PRIOR TO CONSTRUCTION. ANY LIABILITIES DUE TO ERRORS OR OMISSIONS ON THIS PLAN ARE TO BE ASSUMED BY THE CONTRACTOR/OWNER.
 - HOME DESIGNS OF BATON ROUGE HAS THOROUGHLY ENJOYED WORKING WITH YOU. WE SINCERELY APPRECIATE YOUR BUSINESS AND LOOK FORWARD TO WORKING WITH YOU AGAIN SOON.